

KURVE™

WASH BASINS



Engineered for Commercial Use.
Designed for Everyday Living.

Acorn's Corterra®
Kurve™ Washbasins



Soap
Dispenser



One-Piece
Sprayhead



Individual
Washbasins

Minimal assembly
required for an easy and
timely installation.





Model #3793



Spray
Nozzle



Model #3792

- Meets ADA, TAS, UFAS, and ANSI Requirements. 
- Available in Two or Three-Person Washbasins.
- Corterra® Solid Surface with Integral Shelf Design, Individual Washbasins and Drains.
- Heavy-Gage, Stainless Steel Mounting Frame and Trap Enclosures.
- Infrared Sensor or PushButton Controlled Metered Valve with One-Piece Stainless Steel Sprayhead.
- Anti-Scald Pressure Balancing Mixing Valve.
- Gravity Soap System with Filler Cap.



Corterra® Kurve™ Washbasins – ADA Compliant

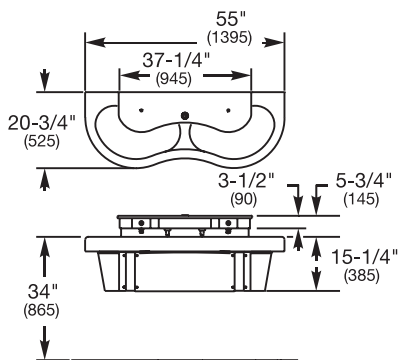

Two Station - Model 3792
(Top & Front View)

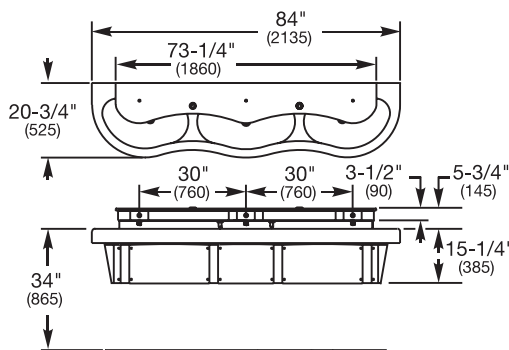

Three Station - Model 3793
(Top & Front View)

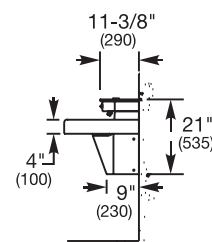

Side View
(Both Two & Three Stations)

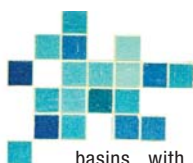

Corterra® Kurve™ Washbasins are engineered to combine the durability of commercial-grade countertops and multiple basins, with the style, flexibility, and accessibility required in today's restroom designs. When installed properly, the washbasin complies with ANSI, UFAS, TAS, and ADA requirements. Compliance is subject to the interpretation and requirements of the local code authority.

Countertop, Basins and Sprayhead Shelf are constructed of Corterra® cast polyester resin (with aluminum trihydrate and other fillers) and conform with ANSI Z124.3 and ANSI Z124.6. Standard color furnish is Smoky Granite Gray. See options for available color selections. Sprayhead is fabricated of heavy-gage, type 304 stainless steel and includes vandal resistant 0.5 GPM flow control spray nozzles. Individual basin provided for each user includes grid strainer. Washbasin includes waste piping assembly with single waste outlet 1-1/2" P-trap.

GUIDE SPECIFICATION Corterra® Kurve™ Two and Three-Person Washbasins by Acorn Models 3792 and 3793 respectively. Conforms with ANSI, UFAS, TAS, and ADA requirements. Provide individual integral basins with individual drains, countertop and top sprayhead shelf constructed of (specify color) Corterra® cast polyester resin (with aluminum trihydrate and other fillers). Washbasins shall conform to ANSI Z124.3 and ANSI Z124.6. Vandal resistant spray nozzles shall be mounted to the underside of the type 304 stainless steel sprayhead assembly. Wall mounted bottom enclosure to be constructed of heavy-gage, type 304 stainless steel and shall conform to ANSI Z124.3 and ANSI Z124.6 load ratings. Basin and sprayhead assembly shall be held tight to the wall by full length engagement with joggle on the bottom enclosure. Washbasin to be furnished complete with the following: valve, checkstops, supply and waste connections. Operation: Manual activation is standard, unless specified with: individual solenoid activated by infrared sensor with plug-in transformer or batteries.

Corterra® Color Options



Imperial Jade



Iverstone



Obsidian



Sahara



Midnight Sapphire



Peppercorn



Smoky Granite



Sunset Stone



Coral



ACORN ENGINEERING COMPANY

15125 Proctor Avenue, City of Industry, CA 91746 U.S.A
Toll Free: 800-488-8999 • 626-336-4561 • Fax: 626-961-2200
www.acorneng.com • info@acorneng.com